



The new senior management team (L-R) Tao Chen, Ethan Pan, director, chief executive Franz-Rudolf Wilbert with senior director Kushuan Yituo Wang and Günter Kronewitter

## Wilbert rescued

German tower crane manufacturer Wilbert Turmkrane has been acquired by Chinese automotive sealing product manufacturer Nanyang Guoyo for an undisclosed sum and has been renamed Wilbert Tower Cranes.

Kushuam Wang becomes the company's new senior director, with Wilbert's former managing director and owner becoming chief executive after signing a new five year contract. All 66 Wilbert employees will retain their jobs and its headquarters will remain in Waldlaubersheim and Stomberg, Germany.

## Huisman to build world's largest crane

Dutch-based heavy lift and offshore specialist Huisman has received a letter of intent for the construction of two 10,000 tonne cranes from offshore oil and gas installation specialist Heerema, for its semi-submersible vessel.

The cranes will be capable of lifting their maximum capacity at a radius of 48 metres and will also feature a 2,500 tonne auxiliary hoist and a whip hoist with a maximum reach of 155 metres. Manufactured at its production facility in Xiamen, China, the new cranes will be tub mounted with 30 metre diameter slew rings.



Huisman has received a letter of intent for the construction of two 10,000 tonne cranes

## H.A.B enters administration

German scissor and boom lift manufacturer H.A.B. Service Center GmbH has appointed an insolvency administrator. The move comes two weeks after the company moved its registered office from Kronau to Celle and changed its managing director from Andreas Becker to Friedrich-Karl Weide.



## King takes on Easy Lift

UK-based King Vehicle Engineering has taken over the Easy Lift spider lift distribution for the UK and Ireland.

Malcolm Kitt who owns Powerlift UK - the Easy Lift and Movex truck mounted distributor and producer of van mounted lifts - has been appointed Skyking regional sales manager. He will now wind down the Powerlift business to concentrate on his new role. King represents Palfinger Platforms and mounts and distributes GSR vehicle mounted lifts in the UK. King chief executive Mark Carrington said: "I have known Malcolm for many years and felt that he would be a great fit with the King team and our plans to introduce new products at the lower end of the height range, whilst also having a good understanding of our existing products from GSR and Palfinger."



Malcolm Kitt with a Skyking badged Easy Lift spider lift

## Martina Moritsch to step down

Martina Moritsch is stepping down as managing director of Terex Tower Cranes and will leave the company at the end of May after 28 years. Moritsch is a member of the family that founded Comedil more than 50 years ago and Recom in 2003. Comedil was acquired by Terex in 1999 and it acquired full control of Recom, which built Terex luffing jib tower cranes, in 2012. The company was rebranded Terex Tower Cranes in the same year.



Martina Moritsch

Moritsch said: "It was an extremely difficult decision to leave a company that has been such a big part of my family and my life. However, with the tower crane market in recovery, I believe the time is right for me to step down, so a seamless transition in leadership can be made to ensure the continued success of Terex Tower Cranes."

Marco Gentilini, currently vice president of business integration will lead the tower crane business in addition to continuing with his current role.



Marco Gentilini

Terex Crane president Tim Ford added: "We sincerely thank Martina and the Moritsch family, for years of dedication to and leadership of Terex Tower Cranes. We are very sad to see her leave, as she is an important part of the Terex story. We respect her difficult decision to step down and wish her continued success in future endeavours."

## Haulotte to update HA16 range

Haulotte is planning to launch completely updated versions of its 16 metre HA16 articulated boom lifts later this summer. The 46ft HA16 has been Haulotte's most popular boom lift almost since its launch. The company built three models, the slightly lower 45ft HA16X with no jib, the HA16PX and HA16SPX. The latter two units have been stretched to create the 51ft HA18PX and HA18SPX. Expect technology from the company's HT23RTJ telescopic that was launched last year. More details in the next issue.



The current Haulotte HA16SPX

# Tadano acquires Cranes UK

Tadano completed the purchase of its UK distributor Cranes UK earlier this month transferring ownership from Joe and Fransie Lyon to Tadano Faun GmbH, at the same time it changed the name to Tadano UK. The company will have four directors, Andrew Plant and Brian Crisp based in the UK, along with Germany based Thomas Schramm, general manager sales & marketing at Tadano Faun and Stephanie Müller who joined Tadano-Faun as chief financial officer last November.

All four were present to sign the official ownership transfer together with Tadano Faun chief executive Alexander Knecht and vice president Satoru Oyashiki. Lyon, 67, founded Cranes UK in late 2001 building the business up to a point where it now has a share of the All Terrain market in excess of 25 percent. Tadano confirmed that no changes in strategy, staff or policy were planned for the UK business.

*The deal is concluded - Alexander Knecht of Tadano and Joe Lyon of Cranes UK*



*Fransie and Joe Lyon before the change over*



*The new team (L-R) Satoru Oyashiki, Stephanie Müller, Thomas Schramm, Brian Crisp, Andrew Plant and Alexander Knecht*

## Denka deliveries flow again

Denka, the Danish trailer and auditorium lift manufacturer rescued by German-based Rothlehner is back in production at the company's German facility some two years since the manufacturer first filed for bankruptcy. Production is now being ramped up as order intake starts to grow and deliveries of new Denka trailer lifts commence.

"The operations are returning to normal and we see that our performance from month to month is growing," said chief executive Manfred Rothlehner. "Manufacturing the standard trailer equipment such as Junior 12, DK18, DL18, DL21 and MK25 is already underway and the first narrow DL22N and DL28N trailers are also in progress. At the end of the year the big DL25 and DL30 will be produced."

*Manfred Rothlehner (L) hands over the first Rothlehner produced Denka Junior to Björn Carlsson of Carlsson & Co, Sweden.*



## Effer launches five new models

Effer is launching five new loader cranes, while ending production of the Effer 440, 470 and 850 models. It has also re-organised its crane line into different families according to lift capacity and control systems. The main groups are now called 'Progress' fitted with the DMU 3000 Plus load control system, while 'H' versions - without load control devices - will be sold in emerging markets.



*Effer has added new loader cranes and reorganised its ranges*

New models include the 50 tonne/metre Effer 505 and 40 tonne/metre 455 fitted with the DMU 3000 Plus electronic load and ESS stability control devices. Effer has also updated its 80/90 tonne metre, 34 metre reach 850 model, launched 12 years ago, with the DMU 3000 Plus and ESS systems. One of its most popular models - the 305 - is now equipped with the DMU 3000 Plus and becomes the 315 Progress. Also upgraded are the 225 and the 255 and the 655. All Progress cranes are available with optional proportional control stabilisers.

## JLG ships first 1850SJs

The first production units of JLG's new 185ft 1850SJ boom lift have shipped from the company's McConnellsburg facility.

The shipments have begun barely four weeks after its official launch at Conexpo, although the unit has been in development for some time and was shown to journalists in early February. JLG declined to comment on which companies have received the first shipments, but Jerry Reinhart's Skyworks of Buffalo, New York claims to have received one already. Skyworks enjoys taking notable units, it purchased JLG's 100,000th boom lift in a charity auction back in 2007.



*The first production unit of the JLG 1850SJ boom lift leaves the JLG plant*

## 10 VPC Manitowocs for ALL

ALL Erection & Crane Rental has purchased 10 of Manitowoc's new MLC300 crawler cranes featuring the company's Variable Position Counterweight (VPC) technology. Launched at Conexpo along with the 650 tonne MLC650, the MLC300 features a 96 metre boom, an optional 30 metre fixed jib attachment and a 96 metre luffing jib which extends the system length to 144 metres. The revolutionary VPC system automatically positions the counterweight in the optimum position for the required lift, while maintaining overall weight balance over the centre of the tracks.

Hire software that will grow your business  
Migrate to Syrinx, it's easier than you think  
See page 38 for companies who made that decision

**SYRINX**  
www.higherconcept.co.uk  
Tel: +44 (0) 118 956 9577

## Sennebogen moves UK crane distribution

Sennebogen has appointed AGD Equipment as distributor for its full range of construction cranes in the UK & Ireland.

Stratford-on-Avon based AGD will also provide parts and service for new and existing Sennebogen customers and says it will be investing in machines for its rental fleet. The current distributor E.H. Hassell will now focus its efforts on Sennebogen's material handling equipment and harbour cranes. Sennebogen construction cranes range from eight to 300 tonnes. AGD will continue to represent Marchetti telescopic crawler cranes in the UK & Ireland.



A 90 tonne Sennebogen HD crawler 690

## Geda transport platforms for Ramirent as regs change

Ramirent Finland has taken delivery of 45 Geda transport platforms after the Department of Occupational Safety and Health officially authorised the use of transport platforms on construction sites in Finland. Prior to the change regulations had prevented the use of transport platforms for moving people on building sites. The order consists of 25 Geda 300 Z/ZPs and 20 500 Z/ZPs.



Ramirent has taken delivery of 20 Geda 500 Z/ZPs transport platforms

## LUXcranes luffer delivered

The first LUXcranes MTL220-10 hydraulic luffing jib tower crane from MTL Cranes is now working in London. The largest in a range of four cranes, the MTL220-10 has a maximum capacity of 10 tonnes and a 55 metre jib with which it can handle 3.1 tonnes at maximum radius. Other models include the MTL100-6, the MTL120-6 and MTL170-8.

All motions on all models use stepless frequency controls, with low ampage draw and canbus electrical systems built into the switchgear cabinet. One of the key features of these new cranes is their small out of service radius

- 9.6 metres for all models - although when in service this reduces to two metres. The MTL cranes have been designed from the start to handle higher wind speeds than the regulations require (161kph/100mph). Maximum free standing heights range from 39 metres on the 100-6 to 54 metres on the 220-10, dependant on tower and base used.

LUXcranes/MTI pioneered hydraulic luffing tower cranes, as distributor for Jost hydraulic tower cranes in the UK and elsewhere. Having designed its own flat top cranes a few years ago, it decided to introduce its own hydraulic crane, in order to have full control of the design, development and product support.

The first LUXcranes MTL 220-10 at work on a site on London



## MBO at Scholpp

Martin Scholpp has purchased the German crane and transport division of the Scholpp group, returning it to family ownership. The move comes a year after German private equity firm Odewald & Compagnie took a 49 percent stake in the Stuttgart-based international lifting group. Scholpp ended his operational duties at the group at the end of March, although he retains a stake in the business.



Martin Scholpp

The new company has a fleet of 30 All Terrain cranes and 80 employees. Scholpp Crane & Transport will continue to work closely with the Scholpp group and share premises in Stuttgart, Karlsruhe, Heilbronn. No details of the transaction or its effect on the shareholders stakes in the group have been released.



Scholpp's new Terex AC500-2

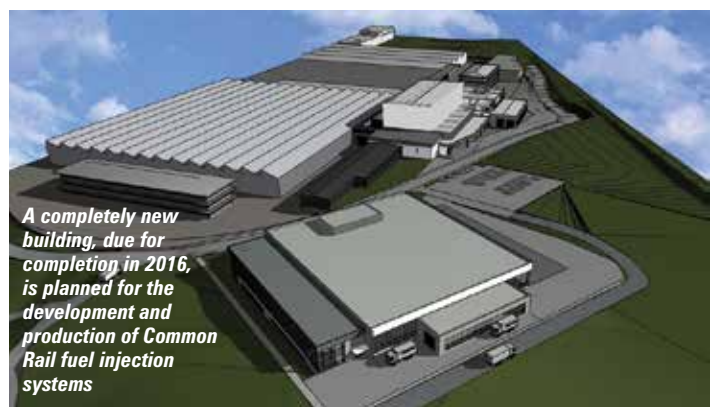

A completely new building, due for completion in 2016, is planned for the development and production of Common Rail fuel injection systems

## Big investment in Switzerland

Liebherr will invest CHF200 million (€164 million) over the next six years, to expand its diesel engine/fuel injection plant in Bulle in the Swiss canton of Fribourg, adding 9,000 square metres of space. Liebherr Machines Bulle develops and produces diesel and gas engines, fuel injection systems, hydraulic components and splitter boxes used in its own equipment and for sale to others.

## Liebherr adds 53K

Liebherr has unveiled its new 53K self-erecting tower crane. The new 50 tonne/metre K series crane fills the gap between the 42K.1 and the 65K and is said to offer an improved erection system, more power and safety features.

The 53K has a maximum capacity of 4.2 tonnes and a hook height, with horizontal jib of between 15.8 and 31 metres. The telescopic lattice tower features a rapid climbing system, allowing up to three additional sections to be added. The hook height can be increased to 43.1 metres when the jib is luffed to 20 degrees above horizontal. Maximum radius is 40 metres, at which the crane can lift up to 1,100 kg. See the new crane at Vertikal Days.

The new Liebherr 53K



# Crane operator fined

The operator of the crane that overturned in Neuenstadt am Kocher, Germany last June, while lifting people - injuring 16 - has been fined. The four axle Tadano All Terrain - owned and operated by crane rental company Scholpp - was lifting a purpose-built enclosed viewing cabin at a school fate when it overturned injuring the five children and eight adults on board. Three others were also injured in the incident.

The District Court in Heilbronn found the 48 year old operator guilty of Negligent Injury and fined him €2,700 after an investigation discovered that the crane had been programmed incorrectly and that not enough counterweight had been installed for the load chart selected. The incorrect programming then permitted him to take the load out to a greater radius than was planned.



The crane simply overturned after lifting to a greater radius than the installed counterweight allowed



The boom landing on a nearby roof may have saved several lives

# First Liebherrs for King

UK crane rental company King Lifting has taken delivery of two new Liebherr LTM1060-3.1 All Terrain cranes - the first two Liebherr cranes to enter its Terex dominated fleet. The 60 tonne three axle cranes have 48 metre main booms, 16 metre swingaway extensions, all wheel drive and steer and a flexible counterweight configuration system.

Director Tristan King said: "The engineering and build quality of the Liebherr products is something that has continually impressed us. In fact we have been so pleased with the operation of these two cranes that we have placed an order for three more."

Richard Everist, managing director of Liebherr Great Britain/Ireland added: "These two LTM 1060 3.1 will soon be followed by an LTM1300 which they have on order. I wish King Lifting every success as they grow their business."



Richard Everist (L) of Liebherr with Tristan King (R) of King Lifting

# H.E orders 250 telehandlers

UK rental company H.E Services has ordered 250 Manitou telehandlers from the manufacturer's dealer, Glosrose Construction in an order worth £10 million. The order consists of a large number of nine metre MT932s, 13 metre MT1335s, 18 metre MT1840s and six metre MT625T compact telehandlers.

H.E managing director Peter Durey said: "The purchase of the new Manitou machines underlines our strategy of having the most up-to-date fleet in the UK, comprising the most advanced and productive machines on the market. We have enjoyed an excellent relationship with Glosrose Construction over the years and had no hesitation in increasing the number of Manitou telehandlers in our fleet."

H.E Services has ordered 250 Manitou telehandlers in an order worth £10 million



# Time expands in China

Time Versalift is expanding its presence in China through its existing distributor Beijing-based Doubletree Systems, which has signed contracts with two new assembly plants in Beijing and Nanjing. The new contracts are intended to help Doubletree cope with increased demand for Versalift platforms in the local market. Time export manager Per Torp and sales manager for Asian markets Torben Pedersen visited the new partners - Nanjing Aerosun and Beijing Beiling Special Automobile - to inspect the assembly and mounting for their first Versalift platforms.

"The new partnership will allow us to export more platforms to China and give the Versalift brand a stronger geographical presence, particularly in the southern and central parts of China," said Torp.

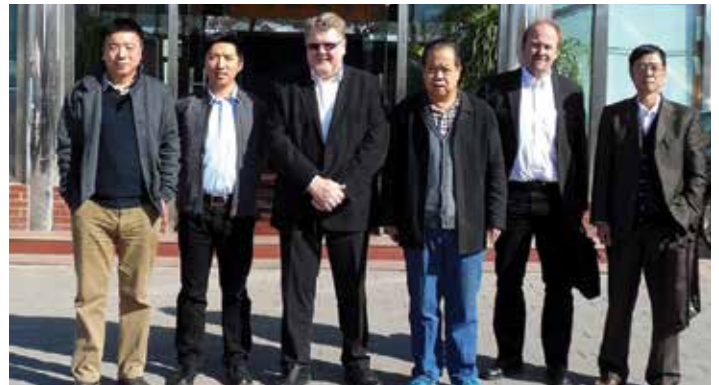

Per Torp (centre) and Torben Pedersen of Time Versalift with new partner firm Beijing Beiling Special Automobile.



## MCS has helped Fork Rent increase automation and efficiency

"Installing MCS-rm has helped us significantly. It has improved efficiency, ensured our continued growth and increased customer satisfaction."

Worldwide, successful hirers choose MCS software solutions. Find out how we can help you build a more competitive rental business. Call us on +44 (0)1628 828 000 or visit [www.mcs.co.uk](http://www.mcs.co.uk)





**PICK and CARRY**



ORMIG S.p.A. PIAZZALE ORMIG  
 P.O. BOX 63 - 15076 OVADA (AL) ITALY  
 TEL. (+39) 0143.80051 r.a. - FAX (+39) 0143.86568  
 E-mail: mktg@ormigspa.com - sales@ormigspa.com  
 www.ormig.com - www.pickandcarry.com



# Terex launches biggest luffer

Terex Cranes unveiled its largest luffing tower crane to date, the 1,600 tonne/metre, 66 tonne maximum capacity CTL 1600-66 - at a customer event held at its test facility near Fontanafredda in Italy.

The crane is almost 50 percent larger than its previous range topper - the 45 tonne CTL 650F-45 - and can lift 16 tonnes at its 75 metre maximum jib tip. Terex's dealer in the UK - Select Plant - has ordered the first two production cranes which are thought to be heading for contracts in the Manchester and London areas.

The new luffer uses the new HD33 tower system which consists of six metre by 3.3 metre sections with pre-assembled ladder, tower platform and a new connection system. Terex engineers said the tower would also be suitable for a larger luffer model up to 2,000 tonne/metres should demand for such cranes exist.



The CTL1600-66 can lift 16 tonnes at the end of its 75 metre jib

For more information see the Tower Crane feature on page 22.



The new HD33 tower system uses six metre by 3.3 metre sections

## New lightweight van mounts

Time International claims it has developed the world's lightest series of van mounted platforms. The Light Duty series consist of the 9.2 metre ETL-26-115 and 10.5 metre ETL-30-130-F - the latter features

a 90 degree articulated jib, A-frame outriggers and dual joystick controls. Weighing less than 3,000kg the low weight has been achieved through a combination of innovations and by using a shorter, lower Mercedes Sprinter van with a wheelbase of just 3,250mm.

Time International chief executive Per Torp, said: "Previously, technicians were restricted with a 3.5 tonne van mounted access platform because the weight quickly approached or even exceeded the 3.5 tonne mark as fuel, people, equipment and cargo essential to everyday use was loading onto the vehicle. That is not an issue in the new Light Duty series."

The new Versalift Light Duty ETL-26-115 from Time International



# A new Magni

Magni Telehandlers has introduced a new 360 degree 5,000kg/23 metre RTH 5.23 Smart telehandler joining the nine model range launched at Bauma last year. The Smart version is mounted on a smaller chassis than the original RTH 5.23 and is equipped with pivot type outriggers, rather than the beam and jack of the regular models, for speed and simplicity.

Magni claims a similar load chart to competitive 25 metre models, but with a substantially lower price due to its lower height. Most of the other Magni features such as the pressurised full visibility air conditioned cab, 100 percent air filtration and interactive touch screen interface with integrated diagnostics and telematics are included as well as the choice of JCB or Mercedes power units.



The Magni RTH 5.23 Smart

# New telescopic from Isoli

**C&A**

news

Italian truck mounted lift manufacturer Isoli is planning to launch a new range of 3.5 tonne PT telescopic aerial work platforms. The new line will include models with working heights of 14, 16 and 20 metres, simple controls, compact dimensions, 250kg platform capacity and a fully proportional automatic overload and control system, which adapts to a wide variety of stabiliser set-ups and working envelopes.

The entry level model is a very simple 14 metre PT 140 with a two section boom and 8.7 metres of outreach with a completely unrestricted 250kg platform capacity.

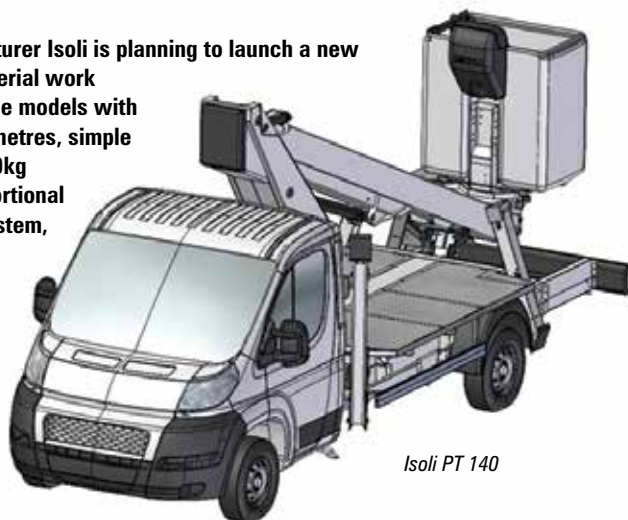

Isoli PT 140

# Wireco acquires Endenburg

US wire rope specialist WireCo has acquired the assets of Dutch wire rope, chain and lifting gear distributor Endenburg. As part of the deal, WireCo will establish its own crane rope distribution centre at Endenburg's current Gouda location - rebranding it as the WireCo Crane Centre - and has appointed Marc Altena as general manager.

The centre will exclusively supply WireCo's distribution partners and select OEM's, focusing on Casar and Oliveira ropes. WireCo's German fabrication and distribution centre is unaffected by the acquisition.

WireCo senior vice president Blake Chandler said: "The new distribution centre in Gouda will allow us to adjust to changing markets by reducing order to shipment turnaround time."



**WireCo**  
WorldGroup



## PNT 205 NLX Truck mounted platform

Max working height 20.1m

Maximum outreach 9.5m

230kg Platform capacity

H Type outriggers front and rear

Zero tailswing

Minimum under-basket obstruction



ISOLI S.p.A  
Aerial Work Platforms – Breakdown Trucks – Specialist installations  
Via Boschi 44 – 35014 Fontaniva (Padova) Italy  
Tel + 39.049.9438611 Fax +39.049.9438600  
exportdept@isoli.com – www.isoli.com



**ISOLI**  
SINCE 1946

# Financials round-up

First quarter results and preliminary revenue reports have been coming in thick and fast while a few stragglers posted their final 2013 numbers. The following is a brief review of the latest financial reports.

## Upbeat United triples profits

US-based United Rentals got off to a strong start to the year with a seven percent rise in first quarter revenues to \$1.18 billion, while more than tripling pre-tax profits from \$30 million in 2013 to \$94 million this year. Rental revenue growth was even more impressive up 9.7 percent to just over \$1 billion as physical utilisation improved a half point to 64.6 percent, which the company says keeps it on target for its full year plan of 68.5 percent.



## Strong start for Lavendon

Powered access rental group Lavendon posted a strong first quarter with rental rates up eight percent and revenues up 10 percent. The strongest growth came from the UK, France and the Middle East, with revenue growth of 10, nine and 13 percent respectively. Belgium edged up four percent, while Germany slipped back three percent, with higher utilisation, but lower rates. Net debt increased from £97 million at the end of 2013 to £108 million at the end March as new equipment was added to the fleet.



## Titan to restructure after profit slump

US-based equipment distributor Titan Machinery has published its 2013 results and announced location closures and layoffs after pre-tax profits dived by more than 70 percent from \$70.7 million to \$18.43 million. Total revenue for the year was \$2.23 billion, slightly higher than in 2012, with increases in replacement parts sales, service and rental, offset my slower sales of new equipment. Headcount in its construction division will be reduced by almost 12 percent through the closure of seven locations.



## Profits slide at Strongco

Despite total revenues up five percent to \$485.7 million Canadian distribution and rental group Strongco saw pre-tax profits slump from \$9.7 million in 2012 to \$3.7 million in 2013 due to higher interest charges and "investments made to drive future growth in the business". Fourth quarter revenues marginally improved to \$116.4 million, while 2012's pre-tax profit of \$847,000 turned into a loss of \$229,000 in 2013.



## Steady progress at Wacker Neuson

Austrian compact equipment and telehandler producer Wacker Neuson saw revenues for 2013 increase six percent to €1.16 billion in both Europe, which still represents 71 percent of sales, and the rest of the world. Pre-tax profits for the period improved 13 percent to €88 million. In the fourth quarter, the revenue trend continued with sales up six percent to €297 million, while pre-tax profits almost doubled to €26.6 million.



## Haulotte up 16%

Haulotte announced first quarter revenues of €89.3 million up 16 percent compared to 2013. New machine sales grew 15 percent, service 26 percent and its residual rental business six percent. The strong improvement came from a 40 percent jump in North America, 30 percent in Asia Pacific and 17 percent in Europe, although this was offset by an 18 percent fall in South America, partly due to high first quarter sales last year. Based on the solid start to the year Haulotte is confident in maintaining its earlier forecast of exceeding 10 percent growth for the full year.



## Mills to raise \$88 million

Brazilian rental and scaffold contractor Mills is planning to issue up to R200 million (\$88 million) worth of unsecured, non-convertible debentures with a five-year term for public distribution/sale. The funds raised will be used to refinance the company's debt, purchase more rental equipment and for general corporate expenses.



## ALE acquires ECR Group

Heavy transportation and lifting company ALE has acquired a majority holding in the ECR group of Gladstone, Australia. The move follows the success of the joint venture 'ALE ECR Heavylift' formed in August 2012. ALE said that the acquisition will provide it with a competitive edge and allow further investment in the business, as well as providing a wider and more integrated service from its smaller scale cranes through to its largest crane, as well as its specialist transportation equipment.



## Telehandlers and access up 17% at Manitou

Manitou has reported a seven percent rise in first quarter revenues, to €291.3 million. The higher sales were led by the Rough Terrain Handling division, largely European produced telehandlers and aerial lifts, where revenues increased 17 percent to €200.9 million. Gehl declined seven percent to just over €60 million, due to high first quarter shipments in 2013. The industrial division slipped 14 percent to €30.1 million. The backlog/order book increased 12 percent to 8,700 units.

All of the growth came from Europe, with Northern Europe up 29 percent and Southern Europe, which includes France, improving seven percent.



# MEC adds hybrids



The MEC Hybrid system for its 4x4 electric drive scissor lifts

MEC has announced a range of hybrid - diesel/electric - power packs for its compact Rough Terrain scissor lifts and Speed Levels.

The company introduced a hybrid system on its Crossover Electric 4wd Series in December 2012 and has now carried the option over to all of its electric powered 4x4 scissor lifts, including the 32ft 3259ERT Crossover, 26ft 2684ERT Speed Level, 30ft 3084ERT Speed Level and 4069ERT Crossover models. The option utilises an on-board Smart generator with three different modes - automatic, manual and manual self-charging - for complete battery re-charging without a need for mains power.

## Special Valla for Hird

Italian crane manufacturer Valla has supplied the UK's Hird group with a special version of the 18 tonne Valla 180E. The 180ES features a new fully hydraulic telescopic 13 metre boom, which can be extended to 16 metres with a hydraulic jib that luffs to 40 degrees. Maximum radius with main boom is 10 metres, at which point it is capable of lifting 1,500kg.

Valla Cranes has supplied the Hird Group with a special version of the 18 tonne capacity Valla 180ES.



## 50 Grove RTs for Chunjo

Chunjo Construction of South Korea has ordered 50 Grove RT770E Rough Terrain cranes following its launch at Conexpo. Seven units are scheduled for delivery later this month, with the remaining 43 units arriving over the course of the year. The 65 tonne RT770E features a five section, 42 metre full power main boom, which can be extended with a 10.1 to 17.1 metre bi-fold swingaway extension.



(L-R) Dave Hull and Larry Weyers of Maniowoc with Jang Hwan Chang of Chunjo Construction and JS Park and John Stewart of Maniowoc at Conexpo.

**A RANGE** Articulated Boom Platforms  
Electric and 4WD Diesel

**X RANGE** Scissor Lifts  
Electric and 4WD Diesel

# TEST US

Come and meet us at: **VERTIKAL DAYS**

May 14th-15th 2014  
Haydock Park - UK  
Outdoor Stand nr. 137

By Aerial and Handling Services  
(AIRO dealer for UK and Ireland)

AIRO by

TIGIERFFE s.r.l.  
Via Villa Superiore, 82 - 42045 Luzzara (RE) Italy  
Tel. +39 0522 977365 (r.a.) - Fax: +39 0522 977015  
E-mail: info@airo.com - www.airo.com

COMPANY WITH  
ISO 9001 CERTIFIED  
QUALITY SYSTEM

Member



# Experience safety first-hand.



## HBC radio systems: quality "in action".

Discover a new generation of radio controls with many great functions and features; e.g. the new technos 2 transmitter with color LCD screen, live camera assistance and many other HBC Smart Options. You will clearly benefit from enhanced safety, efficiency and operating comfort.

## New from HBC: Live camera assistance by radiomatic® photon.



Visit us:

Vertical  
days

CeMAT

hall 27,  
booth D31

HANNOVER - GERMANY  
18 - 23 MAY 2018

### Experience HBC quality live at hand:



Handle demanding operations conveniently with the new spectrum E transmitter.



Control industrial cranes and chain hoists easily and efficiently with the FSE 308 and FSE 312 plug & play receivers.



Operate your application perfectly with your personal choice from our wide product range.



Manage access rights and gather operational information conveniently by radiomatic® report.

**HBC**  
radiomatic

HBC-radiomatic GmbH  
Haller Strasse 45 - 53 • 74564 Crailsheim • Germany  
Phone +49 7951 393-0 • Fax +49 7951 393-50  
info@radiomatic.com • www.hbc-radiomatic.com

- Life-long crane man **Mel Sachett** of Technical Lifting Solutions in the UK has died suddenly from a heart attack, he was 67.



**Mel Sachett**

- MEC** has confirmed **All Access 24** of Stockholm as its distributor for Sweden and Denmark.
- A new company has registered in the UK - **Summit Platforms** - with Grant Woodward as sole director.
- UK rental company **Berry Cranes** has taken delivery of a four axle **Grove GMK4100L**.
- UK-based **ABA Crane Hire** has taken delivery of a **Böcker AK44-4000** truck mounted crane.
- Roland Sundén**, 61, has been appointed president of **Hiab**.



**Roland Sundén**

- Able Equipment** of Long Island, New York has opened a third location in the Philadelphia area.
- Cramo** has acquired **C/S RaumCenter** in Germany.
- Singapore-based **Moh Seng Cranes** has taken delivery of the first **Liebherr LTM 1750-9.1** in South East Asia.
- German access company **Schöttker** has taken delivery of four **CTE ZED 20.2 HV** truck mounted lifts.



**An Steylemans**

- Sarens** has appointed **An Steylemans** as group communication manager.
- Spider** suspended platforms has appointed **Greg Parker** as district sales representative.
- Malina Crane Hire** has taken delivery of the first **Terex Explorer 5800** in the Czech Republic.

- Babcock South Africa** has added nine new **Tadano** cranes to its rental fleet.
- Northern Stevedoring Services** has ordered a **Liebherr LHM 420** mobile harbour crane.



**Erik Høi**

- Erik Høi**, senior vice president of **Ramirent Denmark** has left the company.
- Tagattach** has appointed **Brasco Safety** of Alberta, as distributor for Canada.

- Kosran** is seeking an investor for its new access control technology.
- Cramo** has acquired Finnish compact earthmoving rental company **OptiRent**.

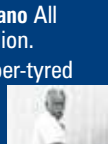

**Russ Guthery**

- Hewden** has taken delivery of 14 **Tadano All Terrain** cranes in a deal worth £9 million.
- Konecranes** has launched a new rubber-tyred gantry crane, the **Boxhunter**.

- Aerial lift veteran **Russ Guthery** - **Mark Industries**, **Weber** (Bandit scissors) and **Condor/Calaver** - has died aged 73.

- US crane company **Stephenson** has ordered a **Potain Igo T130** self-erector.
- Dutch-based **Pol Hoogwerkers** and **Lumar** have taken delivery of **CMC PLA 250** truck mounted lifts.

- Terex Port Solutions** has launched its first mobile harbour crane - the **Quaymate M50**.

- Leo **'Manne' Terquijeff** of **Merlo** distributor **Rotator** is driving a telehandler from Italy to Finland.



**Leigh Webb**

- Ainscough** has appointed **Leigh Webb** as sales director.

- US-based **Dueco** has appointed **Michael Johnson** as operations manager.

- Terex Cranes** is opening a support base in Singapore headed by **Bradley Abrahams**.



**Bradley Abrahams**

- APS**, the **Isoli** distributor for the UK, has delivered two **Isoli** truck mounted lifts to end user buyers.

- CLE** has signed a new distribution contract with **JMG Cranes** for the UAE and UK.

- Dutch access rental company **Arentis** has taken delivery of three new **CMC** spider lifts.



**Ernie Duncan**

- Ernie Duncan**, founder of Californian aerial lift rental company **ADCO** has died aged 84.

- Forged **PAL** cards were spotted for sale by a street trader in **Bangkok**, Thailand.

- Duke Aerial Lift Equipment** of Atlantic, Iowa, has opened a branch in **Davenport**, Iowa.

- Access rental company **Tayeou** has become **IPAF's** first member in Taiwan.



**Lee Vickers**

- Genie** has appointed **Lee Vickers** as product safety & compliance manager European region.

- A **GSL** scissor lift from 1998 collapsed in Germany seriously injuring a man.

- Cattaneo** has received an order for 40 self-erecting tower cranes from German distributor **BKL**.

- UK-based **1 Up Access** has taken delivery of a 20 metre **RAM Gemini 20.35 PTJ** truck mounted lift.

- Penz Crane** has appointed **Jason Lowthorpe** as UK/Ireland area manager.

- OSHA** is to issue a final rule to raise standards on electric transmission work.



**Jeremy Jowett**

- Nationwide Platforms** has appointed **Jeremy Jowett** as sales & marketing director.

- US-based **Wagstaff** has taken delivery of a 300 tonne **Grove GMK6300L**.

- HSS Hire** has acquired Scottish generator company **Apex Generators** from **Nevis Capital**.

- German crane company **Hüffermann** has taken delivery of a 350 tonne **Liebherr LTM 1350-6.1**.

- German access company **Roggermaier** has taken delivery of four 33 metre **Ruthmann T330** truck mounted lifts.

- US-based **Maxim Crane Works** has taken delivery of 30 new **RT Cranes**.

- Effer** has appointed **Al Mahroos** as its new dealer in the Middle East.

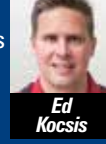

**Ed Kocsis**

- US-based crane manufacturer **Broderson** has appointed **Ed Kocsis** as manager of major accounts.

- German heavy lift company **Megalift** has taken delivery of a 750 tonne **Liebherr LTM 1750-9.1**.

- US-based **Amquip** has ordered 25 **Terex** cranes - 24 **RT555-1 RTs** and a **Superlift 3800** crawler.

- Pakistan Petroleum** has taken delivery of a **Sennebogen HPC 40** truck mounted crane.

- New Zealand's **Daniel Smith Industries** has taken delivery of a **Maeda LC785M-8** mini crane.

- UK **Apollo Cradles** has launched the **FallArrescue** fall arrestor.



**Andreas Stumpf**

- Skyjack** has appointed **Andreas Stumpf** as sales manager for Germany and Austria.

- New Zealand's **Hirepool** has appointed **Brian Stephen** as chief executive, replacing **Mike Foureur**.



**Evelyn Low**

- IPAF** has appointed **Evelyn Low** as regional manager South East Asia.

- UK-based **Mr Plant Hire** is adding **Genie**, **Niftylift** and **JLG** booms and scissors to its fleet.

- US-based **Empire Crane** has taken delivery of a **Shuttlelift CD5520** carry-deck crane.

- Germany's **Wiesbauer** has taken delivery of a 65 tonne **Tadano HK65** truck mounted crane.

- Kimberly Group** has renewed its banking facility with **RBS** for a further five years.

- Julian Wagner** CEO of fire platform manufacturer **Rosenbauer** for more than 30 years, has died, age 63.



**Julian Wagner**

- LiftSmart** material lifts has appointed **Etramo** as its distributor in Europe.

- Christian Regber** has taken delivery of the first 20 metre **Multitel MJ 201** in Austria.

- Mammoet** has supplied its new **MTC-15** terminal crane to the port of **Güiria**, Venezuela.

- US-based **Coast Crane** has ordered 12 **Tadano** cranes, including two 145 tonne **GR-1600XL**.

- Terex Utilities** and **Fassi** distributor **Dueco** has appointed **Karen Hanson** as accounting supervisor.

- US-based **Acme Lift** has appointed **Roger Slagle** as chief financial officer.



**Roger Slagle**

- Palfinger Platforms** has expanded its service/support network in Germany and Austria.

- Haulotte** is building a new larger sales and service facility in Germany.

- Advanced Access Platforms** has ordered 16 **Niftylifts**, 23 **Skyjacks** and 10 **Custom Hybrid lifts**.

- The 1,001st **Potain** crane built in **Pune**, India has shipped to local company **Sai Infraequipments**.

- Australian **Summit Tower Hire** has branded two new 46 metre **Bronto Skylifts** for charities.

- German crane company **Gertzen** has taken delivery of a 750 tonne **Liebherr LTM 1750-9.1**.

- Ireland-based **Crane Hire Ltd** has purchased a 750 tonne **Liebherr LTM 1750 9.1**.

- Philippines-based **ThermaPrime** has taken delivery of eight new **Tadano** cranes.

- Former **EPL Skylift** sales director **Gary Brady** has set up **Furniture Hoists**, sales and rental in the UK.

- John Wheeldon**, one of the first people recruited by **Joseph Cyril Bamford** at **JCB**, has died aged 87.



**Nick Matthews**

- Essex Rental** has promoted its COO **Nick Matthews** to chief executive, replacing **Ron Schad**.

- UK-based **Clements Plant & Tool Hire** has taken delivery of two new **Niftylift 'N'** boom lifts.

- UK-based **Mainline Access** has added four **Genie Z135/70** boom lifts to its fleet.

- Hose replacement specialist **Pirtek** has opened a service centre in Austria.

- UK-based **PSS Hire**, now part of **Ashtead**, has appointed **Mark Hamilton** as its new director.

- Rob McCarthy**, sales manager **Victoria for Bullivants**, has passed away.



**Rob McCarthy**

- Ramirent** director and ex **Lavendon** chief executive **Kevin Appleton** has joined UK-based **Horizon Platforms** as chairman.

See [www.vertikal.net](http://www.vertikal.net) news archive for full versions of all these stories